

Mega Lock - Steel

Round Head

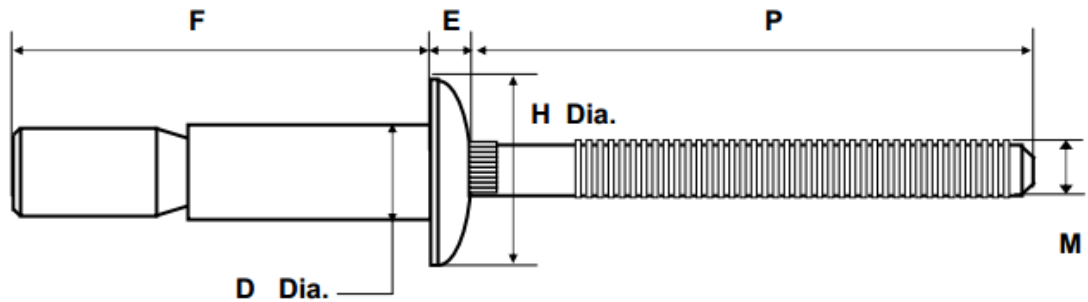

Part No.	Grip Range	Rivet Size	D Max	H Max	E Max	M Max	P Min	F Max	Hole Diam.	Typical Performance	
										Tensile	Shear
MLSR-6-4	1.6-6.9	4.80	4.88	10.20	2.30	3.10	27.00	18.20	4.9-5.1	4450 N	5785 N
MLSR-6-7	1.6-11.1	4.80	4.88	10.20	2.30	3.10	27.00	25.50	4.9-5.1	4450 N	5785 N
MLSR-6-E	1.6-11.1	4.80	4.88	10.20	2.30	3.10	27.00	25.50	4.9-5.1	4450 N	5785 N
MLSR-8-6	2.0-9.5	6.40	6.58	13.50	3.00	4.10	27.00	27.00	6.6-6.9	8230 N	10675 N
MLSR-8-10	2.0-15.9	6.40	6.58	13.50	3.00	4.10	27.00	36.40	6.6-6.9	8230 N	10675 N
MLSR-8-E	2.0-15.9	6.40	6.58	13.50	3.00	4.10	27.00	36.40	6.6-6.9	8230 N	10675 N

Countersunk

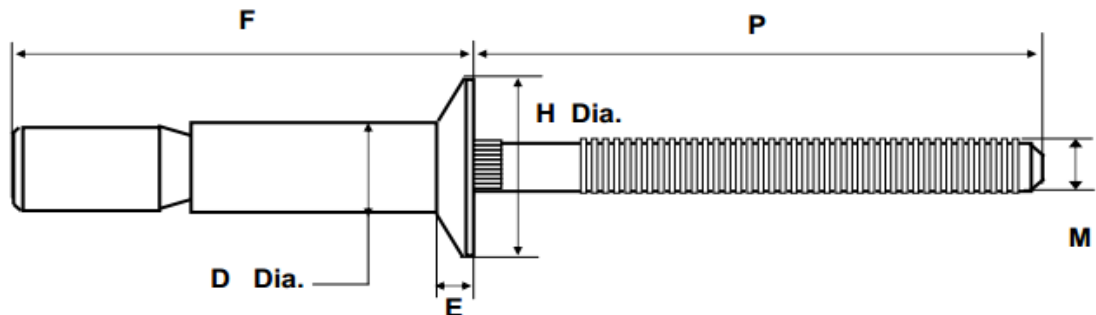

Part No.	Grip Range	Rivet Size	D Max	H Max	E Max	M Max	P Min	F Max	Hole Diam.	Typical Performance	
										Tensile	Shear
MLSCSK-6-6	3.2-8.4	4.80	4.88	9.20	2.00	3.10	27.00	20.20	4.9-5.1	4450 N	5785 N
MLSCSK-6-9	7.7-12.7	4.80	4.88	9.20	2.00	3.10	27.00	26.50	4.9-5.1	4450 N	5785 N
MLSCSK-8-8	4.3-12.1	6.40	6.58	11.40	2.40	4.10	27.00	28.40	6.6-7.0	8230 N	10675 N
MLSCSK-8-12	4.1-17.5	6.40	6.58	11.40	2.40	4.10	27.00	36.50	6.6-7.0	8230 N	10675 N

Material	Body: Carbon Steel
	Mandrel: Carbon Steel
Surface	Body: Clear Zinc Plated
	Mandrel: Clear Zinc Plated