

# Mega Lock - Stainless Steel

## Round Head

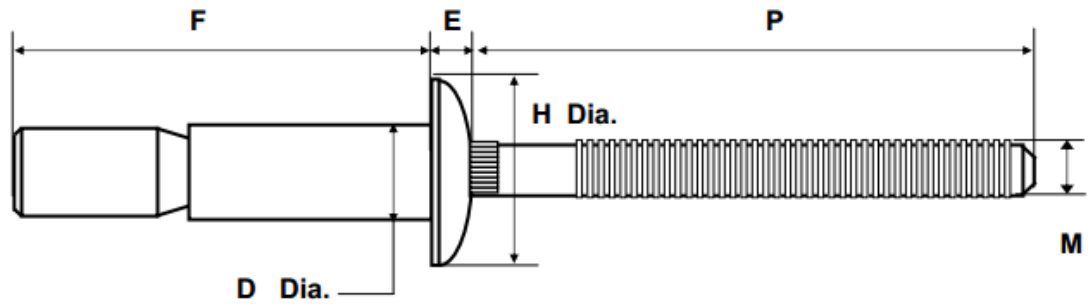

Part No.	Grip Range	Rivet Size	D Max	H Max	E Max	M Max	P Min	F Max	Hole Diam.	Typical Performance	
										Tensile	Shear
<b>MLSSR-6-4</b>	1.6-6.9	4.80	4.88	10.20	2.30	3.10	27.00	18.20	4.9-5.1	4450 N	5785 N
<b>MLSSR-6-E</b>	1.6-11.1	4.80	4.88	10.20	2.30	3.10	27.00	25.50	4.9-5.1	4450 N	5785 N
<b>MLSSR-8-6</b>	2.0-9.5	6.40	6.58	13.50	3.20	4.10	27.00	28.40	6.6-6.9	8230 N	10675 N
<b>MLSSR-8-E</b>	2.0-15.9	6.40	6.58	13.50	3.20	4.10	27.00	36.40	6.6-6.9	8230 N	10675 N

## Countersunk

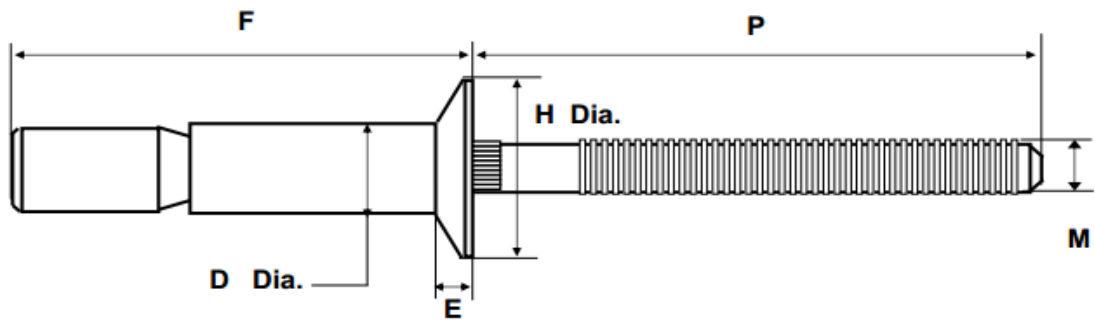

Part No.	Grip Range	Rivet Size	D Max	H Max	E Max	M Max	P Min	F Max	Hole Diam.	Typical Performance	
										Tensile	Shear
<b>MLSSCSK-6-6</b>	3.2-8.4	4.80	4.88	9.20	2.20	3.10	27.00	20.20	4.9-5.1	4450 N	5785 N
<b>MLSSCSK-6-9</b>	3.2-12.7	4.80	4.88	9.20	2.20	3.10	27.00	26.50	4.9-5.1	4450 N	5785 N
<b>MLSSCSK-8-8</b>	4.1-12.1	6.40	6.58	11.40	2.40	4.10	27.00	28.40	6.6-7.0	8230 N	10675 N
<b>MLSSCSK-8-12</b>	4.1-17.5	6.40	6.58	11.40	2.40	4.10	27.00	36.50	6.6-7.0	8230 N	10675 N

Material	Body: Stainless Steel
	Mandrel: Stainless Steel
Surface	Body: Polished
	Mandrel: Polished